

## **MP7954 12V HANDHELD INFLATOR**

### **USER GUIDE**



**Please read and follow this operating manual and all safety instructions carefully when using this device.**

**Keep these instructions for future reference. When passing the device on to others be sure to also include all documentation. The instruction leaflet is also available on our website: [www.maypole.ltd.uk](http://www.maypole.ltd.uk)**

## INTENDED USE

This 12V handheld inflator is designed to be used from the standard 12v DC socket in most vehicles to inflate air beds and inflatables. This product is intended for household consumer use only.

## IMPORTANT SAFETY INSTRUCTIONS

### WARNING

- **Read all safety warnings and all instructions.**

Save all warnings and instructions for future reference.

#### **Work area safety**

- Keep work area clean and well lit.
- Do not operate inflator in explosive atmospheres, such as in the presence of flammable liquids, gases or dust. Power tools create sparks which may ignite the dust or fumes.
- Keep children and bystanders away while operating the inflator.
- The plug must match the outlet. Never modify the plug in any way.
- Do not expose the inflator to rain or wet conditions. Water entering the inflator will increase the risk of damage.
- Do not use if the switch (A) does not turn the inflator on and off when power is connected.
- Disconnect the plug from the power source tool before making any adjustments, changing accessories, or storing power tools. Such preventive safety measures reduce the risk of starting the power tool accidentally.
- Store the inflator out of the reach of children and do not allow persons unfamiliar with the inflator or these instructions to operate the inflator.
- Always check the inflator before use. If damaged, or worn, do not use.

#### **Device-specific safety instructions**

- This appliance may not be used by children or people with reduced physical, sensory or mental capabilities or a lack of experience and knowledge. Children must not use the appliance as a plaything. Cleaning and user maintenance tasks may not be carried out by children unless they are supervised.
- Avoid using the inflator at temperatures below +5 degrees.
- Never leave the inflator unsupervised while it is in use.
- Caution! Operate the inflator only for a short time. The appliance may overheat if operated continuously for longer than 10 minutes. Switch the appliance off immediately and allow it to cool down for at least 10 minutes.

- **Risk of injury!** Do not inflate any objects to more than the intended pressure. They could burst and cause injury and/or material damage.
- Never use the appliance for purposes other than the ones for which it was designed.
- The appliance must always be kept clean, dry and free from oil or grease.
- Stay alert, watch what you are doing and use common sense when operating a power tool. Do not use a power tool while you are tired or under the influence of drugs, alcohol or medication.
- Use personal protective equipment. The use of personal protective equipment such as Eye protection and hearing protection is recommended.
- Remain alert at all times! Never use the appliance when you are distracted or don't feel well.
- Do not carry the appliance by the power cord and never hang it up by the power cord. Always route the power cord away from the appliance to the rear. **Keep cord away from heat, oil, sharp edges and moving parts. Do not use if the cord is worn or damaged.**
- The inflator and hoses can get very hot during operation. Touching them can cause burns.
- The appliance vibrates during operation.
- Never block the inflating or deflating ports whilst operating.
- Never point the inflator towards yourself or others during operation.

## OPERATION

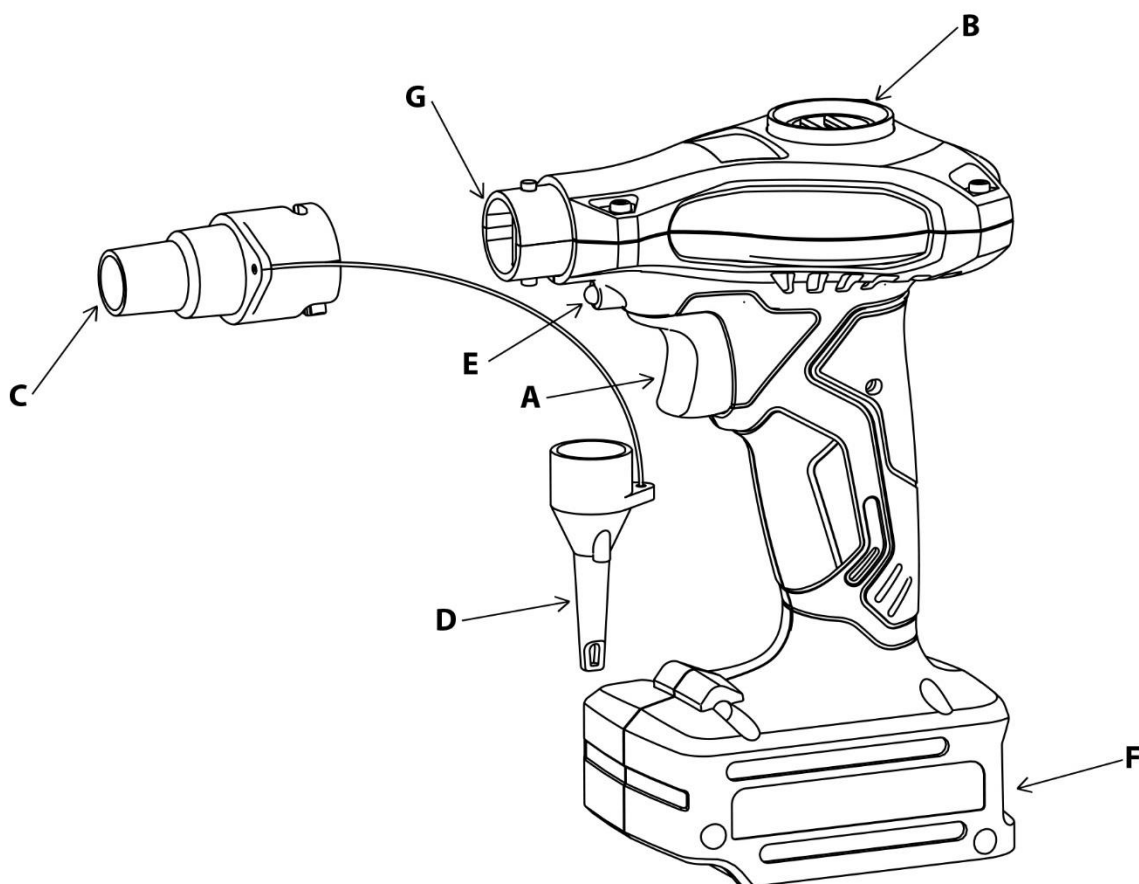

- A = Trigger Switch
- B = Deflation Port
- C = Large Adaptor
- D = Small Adaptor
- E = LED Light
- F = Cable storage
- G = Connection Point

### Applications

The inflator can be used for the following applications:

Large adaptor (C): Cleaning work surfaces, inflating air mattresses and other large inflatables

Small adaptor (D): Inflating beach balls and small inflatables

Deflation Port (B): Quickly deflates air mattresses and other large inflatables

### Inflator Attachments

To install the large adaptor (C) slide the wide end of the attachment onto the connection point (G). Turn the attachment anti clockwise until it is secure.

To install the small adaptor (D) slide it onto the large adaptor (C) until it is secure.

### Power Supply

Plug the 12v DC vehicle connector into the vehicle accessory socket. The LED light will be powered and the inflator will be ready to use.

### Inflating

Select and attach the adaptor (C or D) that fits your application.

Insert the adaptor into the air port on the inflatable item.

Press the trigger switch (A) to start the inflator. The inflator will continue to run until it is turned off.

When the item is fully inflated release the trigger switch (A) to stop the flow of air.

Remove the adaptor from the inflated item and close the item's air port.

NOTE – the maximum PSI for this unit is 1.5PSI

WARNING – do not leave items being inflated unattended whilst in use. These items could burst and cause injury.

### Deflating

Insert the large adaptor (C) into the deflation port on the top of the inflator. Insert the adaptor into the air port on the inflatable item. Press the trigger switch (A) to start the inflator. When the item is fully deflated release the trigger switch (A) to stop the tool. Remove the adaptor from the deflated item and close the item's air port.

## TECHNICAL SPECIFICATION

Item No:	Voltage:	Max Amperage	Max Wattage	Air Flow Rate	Max Pressure
MP7954	12V - DC	4.5A	55W	480L/ Min	1.5PSI

## MAINTENANCE

The only user serviceable part is a 10Amp fuse located in the 12V DC connector, this can be checked by unscrewing the spring loaded centre pin from the plug. Only replace with a fuse with identical ratings. Make sure that the machine is not live when carrying out maintenance work. Regularly clean the machine housing with a soft cloth, preferably after each use. Keep the ventilation slots free from dust and dirt. If the dirt does not come off use a soft cloth moistened with soapy water. Never use solvents such as petrol, alcohol, ammonia water, etc. These solvents may damage the plastic parts.

The machine requires no additional lubrication.

## ENVIRONMENTAL PROTECTION



In order to prevent the machine from damage during transport, it is delivered in sturdy packaging. Most of the packaging materials can be recycled. Take these materials to the appropriate recycling locations. Take your unwanted machines to your local dealer. Here they will be disposed of in an environmentally safe way.

Discarded electric appliances are recyclable and should not be discarded in the domestic waste! Please actively support us in conserving resources and protecting the environment by returning this appliance to the collection centres (if available).

### DECLARATION OF CONFORMITY

We declare under our sole responsibility that this product is in conformity with the following standards or standardized documents:

EN1012-1:2010

EN55014-1:2006/A2:2011;EN55014-2:2017

Technical Manager, Maypole Ltd, November 2019

Email: [sales@maypoleltd.co.uk](mailto:sales@maypoleltd.co.uk)

Web: [www.maypole.ltd.uk](http://www.maypole.ltd.uk)